



**Villages**  
PORT ELGIN

THE **ASHFIELD**  
MADE BY:



Prices and specifications are subject to change without notice. E. & O. E. Window size and location may vary. Actual usable floor space may vary from the stated living area. All stated dimensions are approximate. Actual furniture & fixtures may vary. The location of hydro transformers, utility boxes, streetlights and other infrastructure components have not yet been determined. The components could be situated adjacent to the front yards of any of the lots. ALL RENDERINGS / PICTURES SHOWN ARE FOR ILLUSTRATION PURPOSES ONLY



# ASHFIELD

## INTERIOR STYLES

### STARBOARD SERIES

<b>Cabinets</b> Door Style: Shaker Colour: Pavestone	<b>Countertop</b> Caesarstone Calacatta Nuvo 5131	<b>Ceiling, Interior Doors, Casing &amp; Baseboard</b> Benjamin-Moore White Dove OC-17	<b>Wall Colour</b> Benjamin-Moore Pale Oak OC-20
<b>Flooring</b> Kennedy Floorings Stone Core Natural Wood; River Birch		<b>Cabinet Pull</b> Brushed Nickel	

### PORT SERIES

<b>Kitchen Island</b> Door Style: Shaker Colour: White	<b>Countertop</b> Caesarstone Piatra Grey 5003	<b>Cabinets</b> Door Style: Shaker Colour: White	<b>Ceiling, Interior Doors, Casing &amp; Baseboard</b> Chantilly Lace 2121-70	<b>Wall Colour</b> Benjamin-Moore White Dove OC-17
<b>Flooring</b> Kennedy Floorings Stone Core Natural Wood; Gambel Oak		<b>Cabinet Pull</b> Brushed Oil Rubbed Bronze		

## CANEXEL SIDING COLOURS

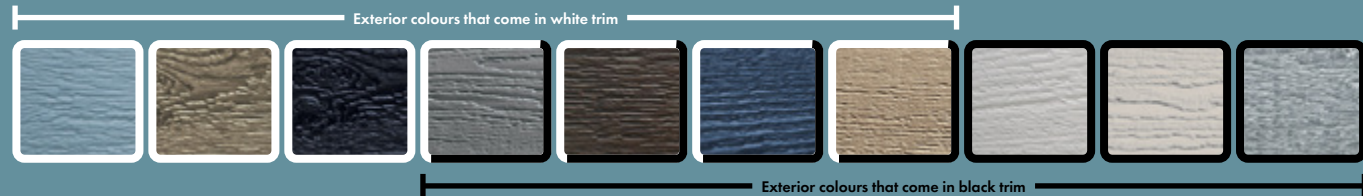

## FIXTURES

<p>Kitchen Faucet - Delta</p>	<p>Bathroom Faucet - Delta</p>	<p>Tub Faucet / Showerhead - Delta</p>	<p>Showerhead - Delta</p>	<p>Toilet - Proflo</p>	<p>Exterior Light - Kichler Ryler</p>
<p>Tub/Shower - Mirolin Belaire</p>	<p>Shower - Mirolin Melrose 5</p>	<p>Bathroom Fixtures - Delta Trinsic</p>		<p>Interior Door Handles - Taymor</p>	<p>Kitchen Island Lights - Russell</p>
<p>Kitchen Sink - Kindred</p>	<p>Vanity Sink - Kohler Ladena</p>	<p>Interior Door - Lincoln Park</p>	<p>Bedroom Flushmounts - Russell</p>	<p>Vanity Light - Russell</p>	<p>Front Entrance Flushmount - Kichler</p>

THE  
**ASHFIELD**  
MADE BY:



# THE ASHFIELD

MADE BY:

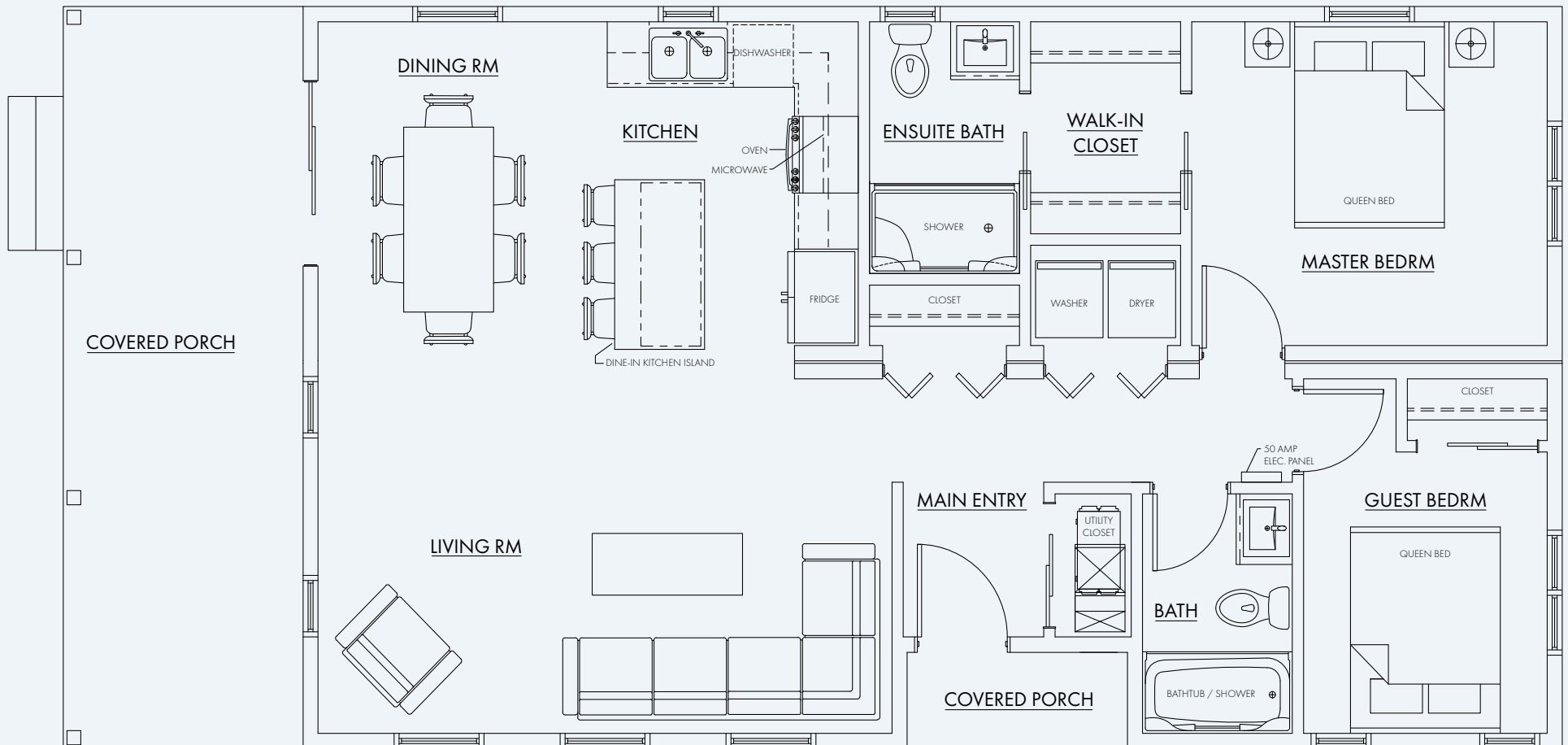



# PHASE 1B SITE PLAN



ASHFIELD UNITS



SOLD LOTS



**Villages**  
PORT ELGIN

**PHASE 1A  
SOLD OUT**